

company portfolio

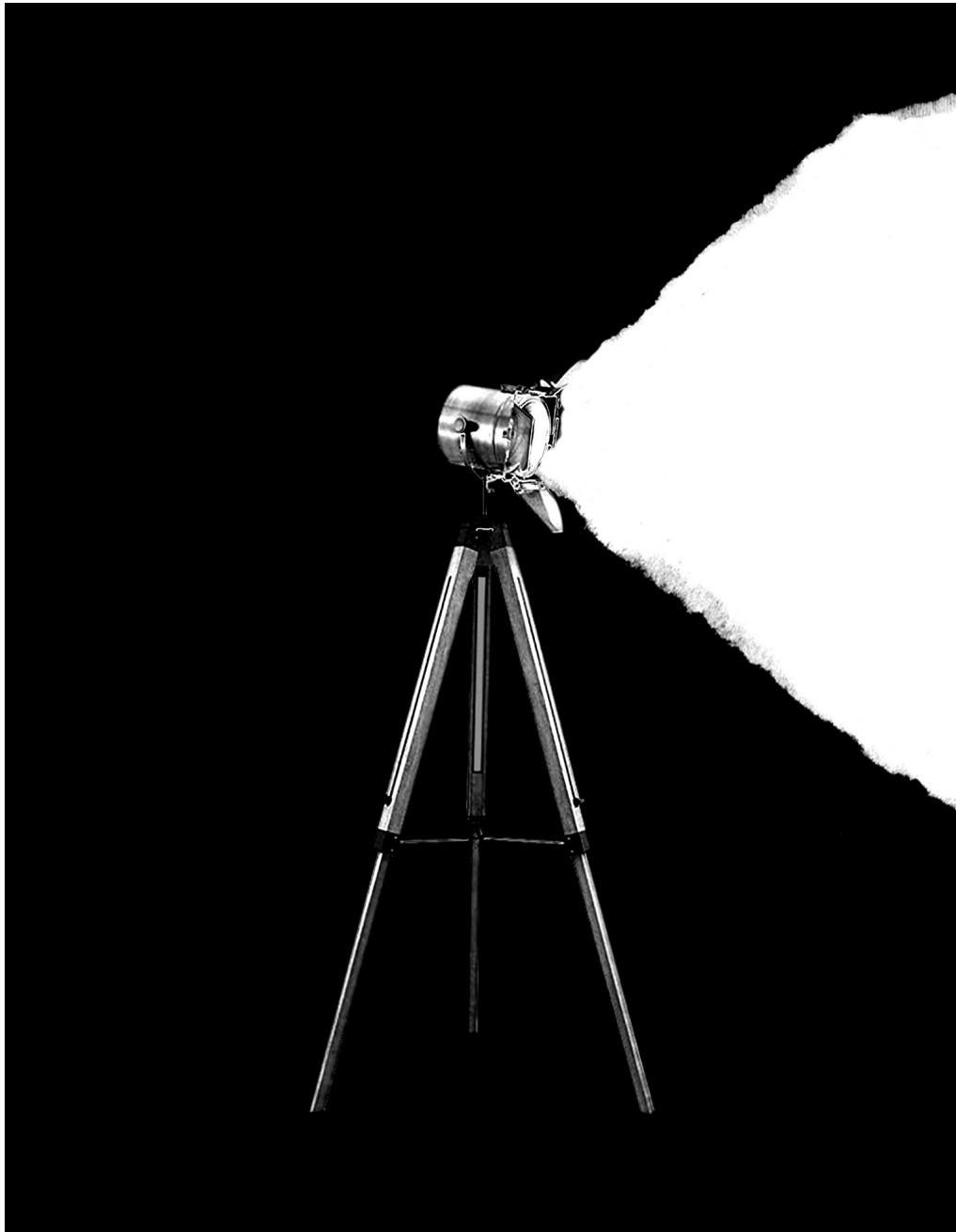

content

philosophy	3
planning & consulting	5
conceptual work	8
expertise – subsections	11
team	25
facts & figures	31



philosophy

When it comes to meeting deadlines, costs and quality, accountability is key.

Projects concerning cultural venues are a challenge for all parties involved. Due to their high costs and complexity, they are in the focus of local politics. Furthermore they have a particularly emotional value for society.

With it's 35 years of experience theapro is a reliable partner as a planner and consultant.

—> We conceive projects holistically

—> We oversee projects from phase 0 up to their completion and beyond. We attach great value to the subject of interim venues.

—> We think outside the box to develop solutions that unite all our fields of expertise as well as the monitoring of the project frame.

—> We unite experience and innovation to achieve optimum results for each project.

—> Consulting – especially in preparation of new projects – is a matter of the heart for theapro.

—> Our network includes the patrons of theatres and concert venues, branch-related companies as well as decision-makers in politics and society.



planning | consulting

With it's 35 years of experience theapro is a reliable partner as a planner and consultant.



With theapro, builders and users find a planner and consultant for integrated event technology and structures. theapro's mission is to develop highly functional and cost-effective venues for most versatile uses.

theapro is bundled competence for the construction of high quality venues.

When it comes to new construction and remodelling, theapro is a consultant for architects, owners and users throughout the project concerning flexible and forward-looking holistic concepts.

Taking the current situation into consideration, requirements regarding cultural buildings have been changing significantly.

As a result many new questions have arisen.

- Which arrangements have to be made today concerning dilapidated cultural buildings to ensure the ability to perform in times of scarce resources that preclude an early remodelling process?
- What will the prospective standard in performance equipment look like?
- Which technological installations will be obligatory, what will the add-on possibilities be and what will they look like?
- How to achieve the maximum sustainability of a building using minimum financial resources?

We are looking forward to advising you in questions like these and questions yet to be asked.

We are looking forward to developing an individual, customized and forward-looking concept taking into account the given budget concentrating on the essentials.

Don't hesitate to get in touch with us for an initial consultation.

Our services in consulting

- > Assessment of demand
- > Translation of utilization concepts into the planning of spacial requirements
- > Performance audit for courses of action
- > Consultation regarding technological choices in the field of stage technology, stage lighting as well as sound and media engineering
- > Planning of flexible construction solutions allowing subsequent alternation and integration processes
- > Planning of maintenance measures while venues are still operating
- > project related advisory services for bulding-owners
- > Coverage of all outputs of the Fee Structure for Architects and Engineers (HOAI) LP1-9 for all of our subsections and interfaces

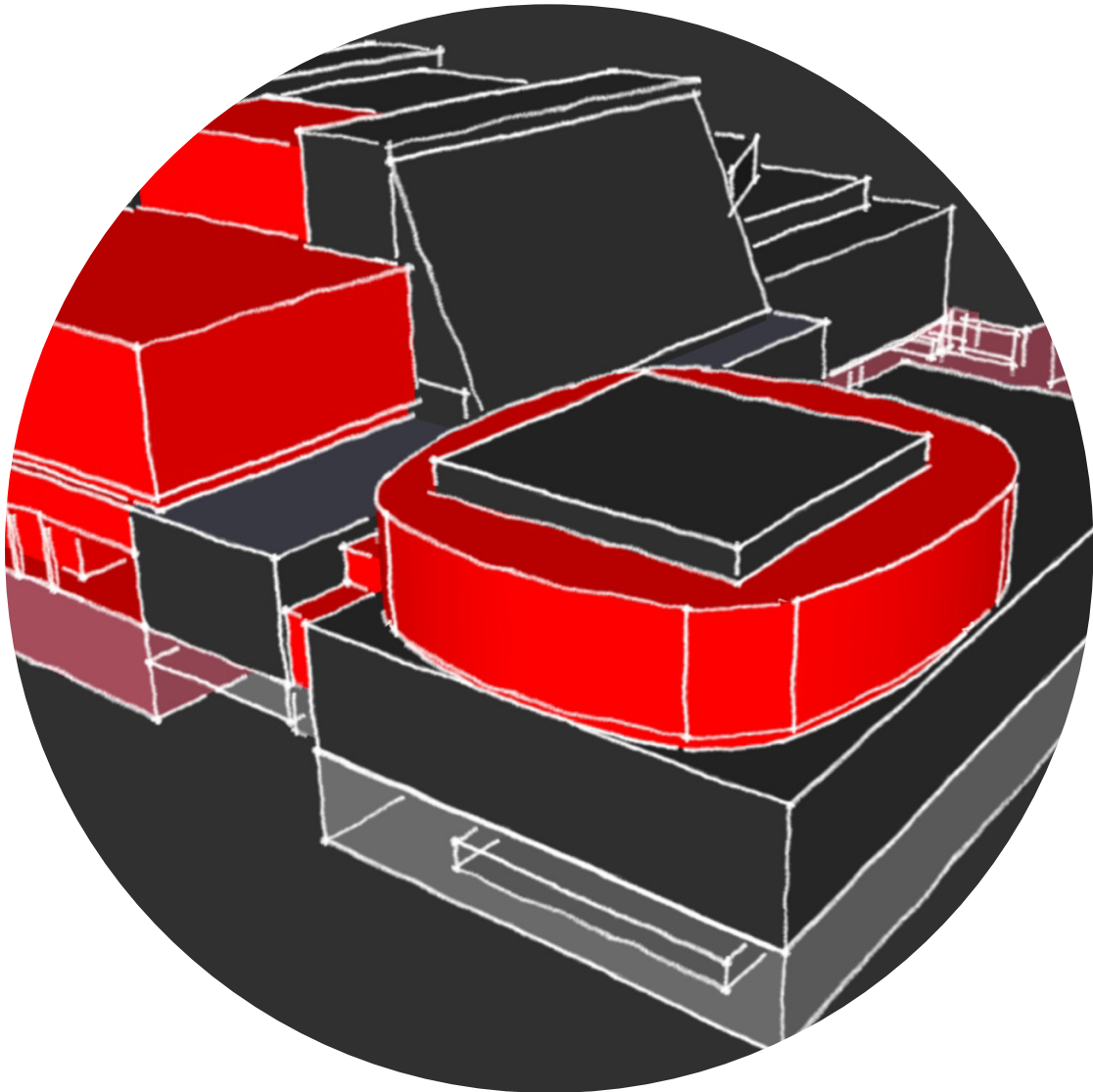

conceptual work

We consider every project
a new challenge.
To the last detail.



Feasibility studies, expert advice and accurate phase-0-studies are the solid foundation for optimal decisions and a successful project kick-off.

At the beginning of a project building owners often seek to determine the most important parameters of a project via a feasibility study.

We examine the frame work with regard to deadlines and finances as well as the implementation of the demanded spacial program with variations. theapro has many years of experience with the preparation of feasibility studies and concepts.

We offer an exceptional wealth of experience gathered through our projects as well as through the know-how of our colleagues, many of them being former employees of German theatres. These conditions provide us with the ability to face projects in an informed and targeted manner.

Our services in conceptual work

- > Preparation of user requirement programmes
- > Evaluation of mandatory rehearsal and storage space
- > Evaluation of existing shortcomings and deficits
- > Review of possible constructional extensions
- > Practicability review of spacial and functional programs
- > Preparation of economic evaluations



expertise – subsections

We make buildings vibrate.

We plan and consult in these subsections

sound and media engineering



stage technology

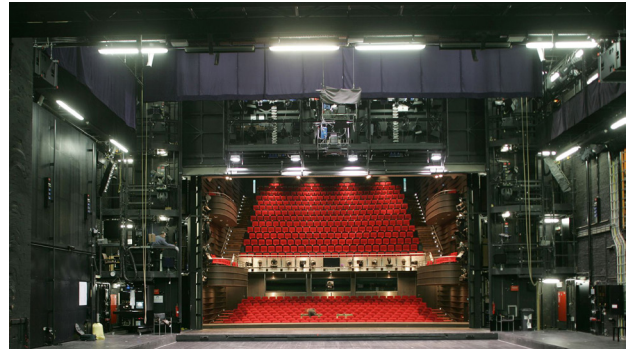

stage lighting



architectural acoustics



interim venues



theatre architecture





sound and media engineering

No matter if digital or analog, copper or glass fiber, autonomous solutions or integrated concepts — we design the ideal and sustainable sound and media engineering infrastructure.

The main task is to transport various data via similar data channels in order to make it accessible from everywhere inside the building.

Distribution networks grow to be open for all types of data. Perfectly interconnected multimedia event locations that are easy to handle and build the user's tools to meet all the expectations for a modern production. The operation of different media follows a tight schedule. Higher level control systems ensure the synchronicity of the preassigned tasks as well as the exact implementation of complex hybrid shows. Usability and quality standards as well as essential redundancies and safety matters form the basis to detect the best and most adjusted solution available.

Thanks to keen market observation and product knowledge in the field of media engineering, personal experience in the event sector and the continuous user feedback, theapro provides a high level of understanding of the individual application.

Our services in sound and media engineering

- > Planning of high quality concepts for media engineering equipment
- > Planning of combined customized infrastructures containing copper or glass fiber, autonomous solutions or integrated concepts
- > Integration of state-of-the-art conference and streaming technologies for conference systems
- > Implementation of modern stage management systems
- > Implementation of low-latency video technology in professional broadcast quality based on network technology or visual dies
- > Planning of immersive sound reinforcement systems for new acoustic experiences in the theatre
- > Planning of professional public address systems



stage technology

During daily operation stage technology is a crucial tool regarding the implementation of artistic ideas as well as ensuring versatility while constructing and converting the stage.

theapro evaluates all requirements necessary, in order to guarantee an organizational optimum outcome in relation to investments.

Of all the technological areas in a theatre, the requirements to accessibility and reliability could not be higher than in the area of stage technology.

The degree of technological extension of a venue decisively defines the operating costs — increased converting speed creates temporal space for rehearsals and additional shows.

In addition to planning state-of-the-art systems we always keep an eye on the market and evaluate wheather or not technologies can be applied to the world of theatre.

Modern electronic control systems are an integral component of modern stage technology systems.

We design and customize control systems, control panels and user interfaces of computerized systems in coordination with the users, taking into consideration the individual operational modes of the venue.

Based on the experiences of former projects we strive for innovational solutions for the future.

Our services in stage technology

- > Design of state-of-the-art systems
- > Development of customized electronic control systems, control panels and user interfaces
- > Customized cost-benefit analysis
- > Evaluation of appropriate stage technology operating systems (electronic, hydraulical, manuel)

We plan

- > Classic upper and lower machinery with integration into the steel construction of the stage / scene surface
- > Platform technology for different kinds of auditorium and event formats
- > Technology for scenic effects
- > Safety technology regarding the protection of individuals and constructional values
- > Technology for transport and logistics



stage lighting

Light has the ability to affect you like no other medium. Next to the set-up-scenery it is the great means of illusion in theatres. theapro plans stage lighting that illuminates objects that need to be seen.

Either the classical stage lighting supports the scenery's artistic message or it dominates and takes control.

In auditoriums lighting accentuates the important people and objects, creating a concentrated atmosphere for the audience.

In architectural lighting on the other hand the central task is to accentuate the architectural message by using lighting design. The intense coordination process between the architect and the lighting planner assures a harmonious result of lighting and it's integrability into existing infrastructures.

We are convinced that the planning of a well designed lighting system needs to be included in the (re-)construction process at an early stage. Further we are convinced that the lighting system needs to be matched precisely with the architectural structure as well as the technological equipment that is integrated into the building.

A clear and logical construction of the lighting system as well as the energy distribution system according to regulations from the input and dimmer system to the plug guarantee a longterm stability.

Additionally, energy efficient lighting planning of venues allows major cost savings.

Our services in stage lighting

- > Design of customized, modern and forward-thinking stage lighting systems upon consultation with the users
- > Planning, tender and construction management of the new or remodelled stage lighting system incl. scenographic stage lighting system and functional lighting (work/blue light)
- > Planning of hall and foyer lighting
- > Planning of slave console systems
- > Design of signal networks for future challenges
- > Optimization of failure safety
- > Design of a new spotlight range according to the options
- > Organisation of shoot outs
- > Consultation and selection of new lighting boards for architectural light
- > Planning and design of modern director's workstations



Architectural acoustics

Architecture and acoustics are the determining parameters for an auditorium's quality. Especially the acoustics of a hall are crucial for the reputation of the entire venue. We support architects in designing ideal venues.

Without doubt architectural acoustics determine the architectural design. The visual aspect of acoustics can be influenced by various materials and their defined acoustic characteristics.

Music and speech shall be clear, comprehensible and brilliant to the ear. The sound impression shall be homogeneous and strong in every single seat. Interfering noise of the building services, the nearby rooms and noise from the street must be absolutely inaudible.

Architectural acoustics and space-creating architecture are closely linked. Therefore belated changes are only possible with great efforts and should be taken into account in the early phases of planning.

We design acoustic concepts for an ideal sound exploitation of event halls as well as for all artistic areas.

Our services in architectural acoustics

- > Development of simulations for the precise calculation of all relevant parameters regarding architectural acoustics
- > Development of auralizations in order to test different kinds of planning and utilization versions
- > Planning of acoustical ratios taking into account preventive measures to protect hearing
- > Implementation of final measurements to test applied planning methods as well as to document



Interim venues

When it comes to restructuring processes, interim venues are an inevitable topic for all theatre users and building owners. We offer professional planning and consulting.



Type A – The tent solution

Known as 'circus tent' this structural type contains tent poles onto which the tent roof is being pulled up and fastened. In doing so the rotary bars support the eave and serve for the lateral anchoring of the roof sheet.



Type B – The tent hall

Known as marquee or 'party tent', the tent hall is being defined as a self ballasted gable roof hall made of aluminium beams and tent sheet in a 5 metre grid. This type appears of high quality due to it's flexible wall options from sandwich panels to glass and double cellular sheets.



Type C – The existing hall

Normally the existing hall is a vacant building of former industrial or recreational use. Therefore it's usability depends on it's history. A preliminary review stating the maintenance measures is crucial with this type.



Type D – The light weight hall

This type aims for an optimized usage for the purpose of theatrical or musical performances by a special roof support structure. Thanks to oversized roof trusses, the hall provides high static reserves for load capacity.

Our services in interim venues

- > Determination of the frame conditions (life cycle, user requirements, environment, budget)
- > Determination of the respective type
- > Development of feasibility studies with variant planning
- > Planning incl. building application and tender
- > Construction management during the implementation phase
- > Consultation regarding dismantling and continued use of the building

We are happy to help you figure out these questions. Feel free to shuffle through our [interim-projects](#) on our website and to get in touch for a free consultation meeting — the sooner during the construction process the better.



theatre architecture

Design, technology and utilization are closely linked together. The precise knowledge of the single areas as well as their interaction are essentially important for an ideal planning of theatre architectural structures. We know exactly what theatres need and contribute to their construction by designing ourselves and by consulting architects.

We are convinced that cultural and event spaces need to have more open and transformable structures.

The plurality of arts and society should be reflected by the possibilities of a building. This also applies for listed buildings that need particularly thorough consideration of balance between conservation, reconstruction, restoration and required changes.

The center piece of our planning is the auditorium. The other functions of a theatre are to be found in its neighboring areas. The auditorium's design, organization and capacity determine almost all of the other measures — the portal width of a proscenium stage theatre as well as the measurement of a concert stage and the proportion of the entire stage.

The quality's scale of an auditorium design is being determined by whether the artists on stage and the audience are able to communicate with one another.

Our services in theatre architecture

- > Requirement planning
- > Development of feasibility studies
- > Development of space and function programs (competition preparation)
- > competition consultation
- > Building planning with tender and construction management, especially interior design of the auditorium
- > Planning of seating systems
- > Integration of the theatre and housing technology into the building planning
- > Logistics planning (i.e. audience, decoration, delivery)



Team

We are an international team consisting of engineers of various disciplines like architecture, civil, mechanical and electrical engineering, as well as sound and media engineering.

executive management



Thomas Lüdicke
owner, CEO
Dipl. Ing. precision engineering



Sabine Netter
CEO
theatre architecture
Dipl. Ing. architect

stage technology



Boris Viehbeck
stage technology, power of
attorney
B. Eng. theatre technology,
M. Eng. event technology



Jens Höpfner
stage technology
Dipl. Ing. theatre and event
technology



Stephanie Arndt
stage technology
B. Eng. event technology



Daniel Rudolf
stage technology
CAD construction, visualization
B. Eng. event technology

sound and media engineering



Ralph Preller
sound and media engineering
SAA certificate
Dipl. Ing. communications eng.



Michael Pfab
sound and media engineering
SAA certificate
Dipl. Ing. electrical engineering



Martin Fischer
sound and media engineering
Dipl. Ing. Data Technology



Julius Busch
sound and media engineering
B.A. Sound and Music Production

stage lighting



Thomas N. Smith
stage lighting
light designer



Björn Gerum
stage lighting (freelancer)
Dipl. Ing. theatre and event
technology



Dominik Söllner
working student stage lighting
B.Sc. Electrical and Computer
Engineering

theatre architecture



Claudio Guillermo Chilabert
theatre architecture,
CAD construction, visualization
Dipl. Ing. architect (UBA)

interim venues



Björn Ley
interim venues, stage lighting,
power of attorney
bachelor professional for event
engineering

construction management



Thorsten Winter
stage tech., construction mgmt
Dipl. Ing. mech. engineering



Jürgen Schröder
project lead/management
marketing specialist, banker



Michael Fromm
construction management
specialst for elect. engineering



Jörg Quadt
construction management



Kolja Ronge
construction management
Generalplanung
B. Eng. Wood technology

construction and visualization

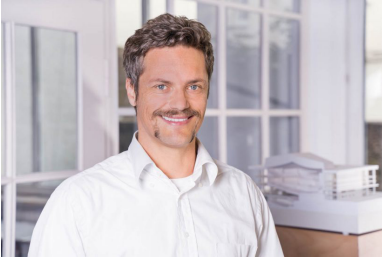

Markus Pusch
CAD construction, visualization
CAD & BIM coordinator



Alfredo Garcia Mariñas
CAD construction, visualization
surveying technician,
draftsman

project assistance



Gisèle Boucard
office management, secretariat
M.A. applied foreign languages
english/german



Franziska Geyer-Gensterblum
project assistance
M.A. of teaching, specialization
german



Jasmin Hajnal-Arndt
project assistance
B.A. international business
administration



Conny Wenke
project assistance
business assistant,
focus foreign languages

accounting



Denise Lüdicke (parental leave)
accounting
event management (IHK)

collaborations



Rose + Imming
Ingenieur-Partnerschaft MBB

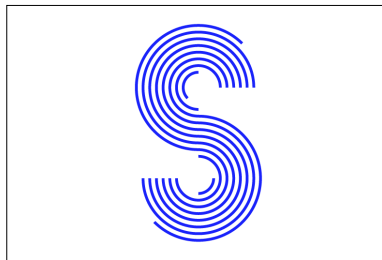

Studio Singer
Partnerschaftsgesellschaft MbB

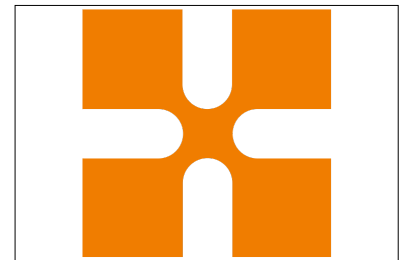

mensch und maschine SE



Planung AB AG

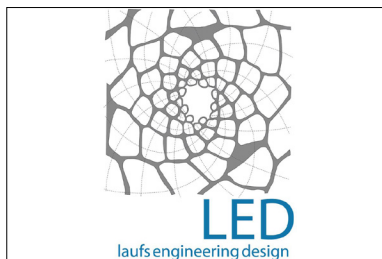

laufs engineering design GmbH



docu tools



facts & figures

We want to provide maximum
freedom for the arts.

theapro is an office with national and international experience. Our focus of activity lies with projects in Germany. Nevertheless we have undertaken projects in Austria, Switzerland, Italy, Greece, Russia, Uzbekistan and the United Arab Emirates.

Our experience is based on approx. 180 Mio. EUR of planned and built event technology during the last 10 years.

—> Founded in 1985 in Munich as a private corporation and transformed into a GmbH in 2002

Visit us on

www.theapro.de

—> Headquarter in Munich with office in Cologne

—> Annual turnover of approx. 2,5 Mio. € net

Our references of the last 10 years

- > Bühnen Köln
- > Residenztheater München
- > Dt. Oper am Rhein Düsseldorf
- > Staatstheater Darmstadt
- > Nationaltheater Mannheim
- > Staatsoper Hamburg
- > Theater Ulm
- > Schauspielhaus Nürnberg
- > Kulturpalast Dresden
- > Staatstheater Augsburg
- > RMCC Wiesbaden
- > Theater Karlsruhe
- > Bühnen Frankfurt am Main
- > Volkstheater München
- > Neue Messe München
- > BMW Welt München
- > Kammerspiele München
- > Deutsches Theater München
- > NDR Sendesaal Hannover
- > Theaterhaus Stuttgart
- > Stadttheater Landshut
- > Theater Nordhausen
- > Konzertsaal München
- > Staatstheater Schwerin
- > Theater Schleswig
- > Theater Bonn
- > Bruckner Universität Linz
- > Mozarteum Salzburg
- > Theater Naumburg
- > Theater Paderborn
- > Theater Trier
- > Theater Lippstadt

picture credits

p. 12, 13 © Baldauf & Baldauf
p. 12, 19 © Schrumpf



We leave the stage at the earliest
after the premiere.

Offices theapro GmbH

Office Munich

Augustenstraße 59
80333 Munich
phone: +49 (0) 89 74 00 53 0

Site office Cologne

Am Alten Posthof 3
50666 Cologne

contacts

info@theapro.de
akquise@theapro.de
interim@theapro.de

www.theapro.de